

# Installation Instructions

## Flexible Clear Polycarbonate Corner Guard

Please read all instructions before installing corner guard.

### Important

1. Acclimate materials 24 hrs before installation. Maintain temperature controlled environment after installation
2. Install in accordance with manufacturer's installation instructions. Failure to do so will void the warranty.

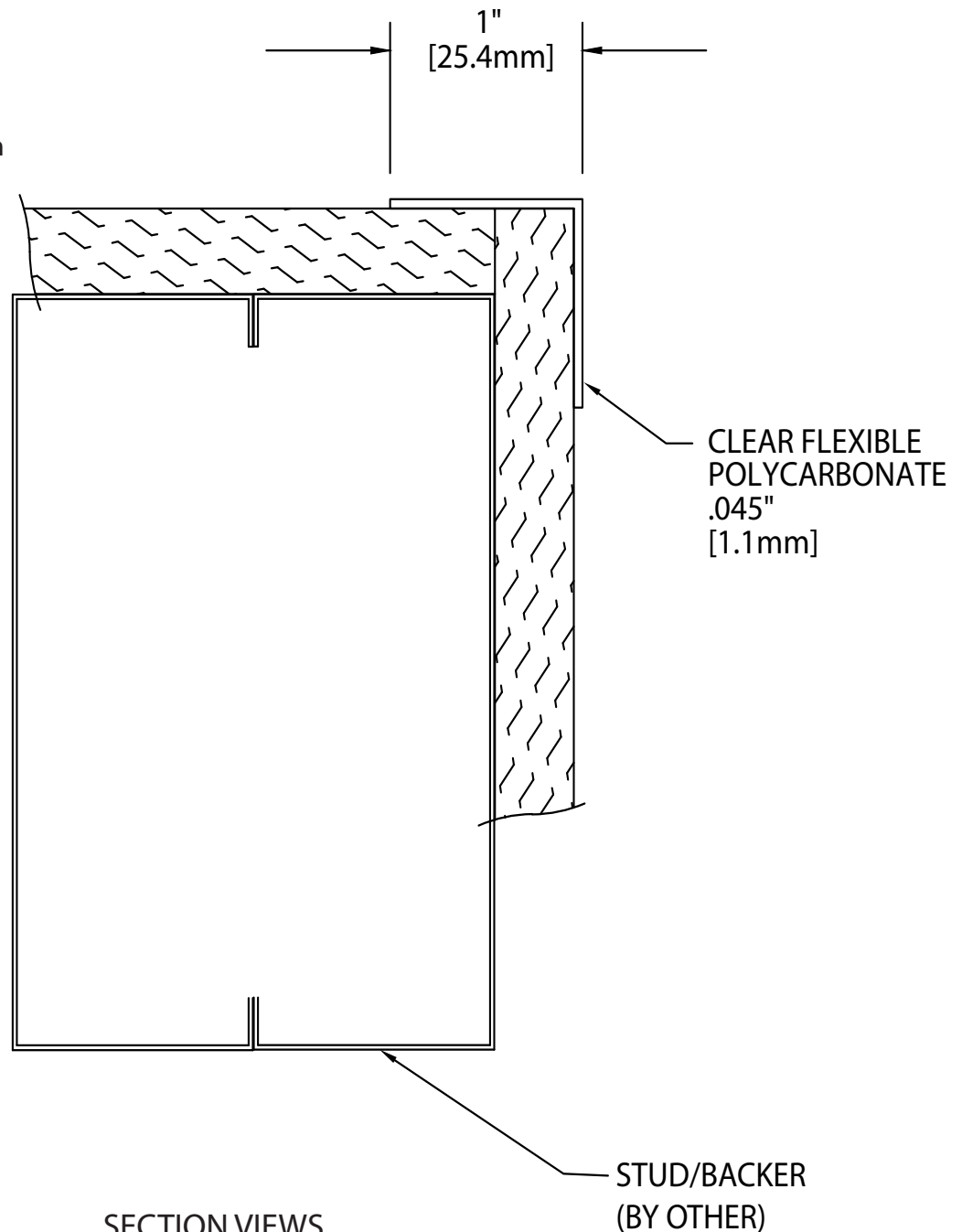

### Recommended tools

Safety Glasses, Tape Measure, Level, Power Miter Saw, 10" Blade with 60-80 Carbide Tipped Teeth

IPC.415/REV.3

IPC® Door + Wall Protection

[inpro.com](http://inpro.com) • 800.222.5556 • 262.679.9010

World Headquarters S80 W18766 Apollo Drive, Muskego, WI 53150 USA

Installation Hotline: 866.394.6776

**inpro®**

# Installation Instructions

Please read all instructions before installing corner guard.

## Flexible Clear Polycarbonate Corner Guard

---

### Components and Fasteners

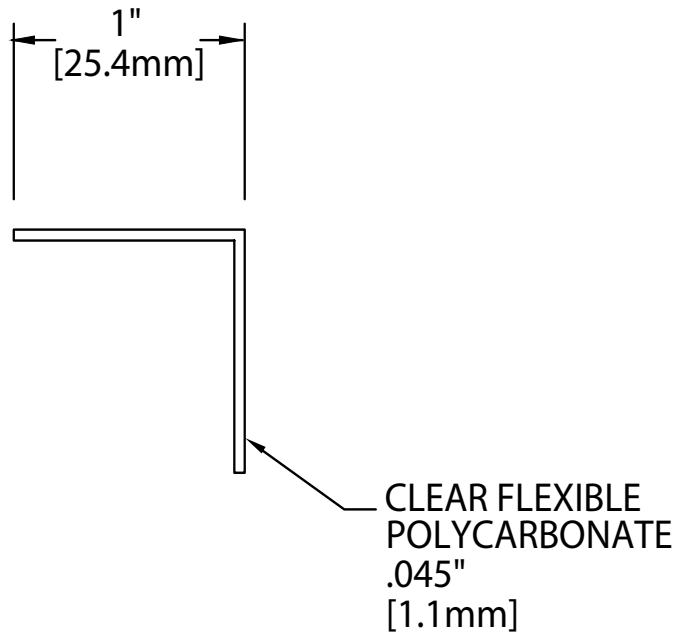

SHOWN AT 1 1/2"

---

IPC® Door + Wall Protection

**inpro.com • 800.222.5556 • 262.679.9010**

**World Headquarters** S80 W18766 Apollo Drive, Muskego, WI 53150 USA

**Installation Hotline:** 866.394.6776

**inpro®**

# Installation Instructions

Please read all instructions before installing corner guard.

## Flexible Clear Polycarbonate Corner Guard

---

Exploded View assembly



FLEXIBLE  
POLYCARBONATE  
CORNER GUARD  
(TAPE ON)

---

IPC® Door + Wall Protection

inpro.com • 800.222.5556 • 262.679.9010

World Headquarters S80 W18766 Apollo Drive, Muskego, WI 53150 USA

Installation Hotline: 866.394.6776

**inpro**®

# Installation Instructions

## Flexible Clear Polycarbonate Corner Guard

Please read all instructions before installing corner guard.

FIG. 1

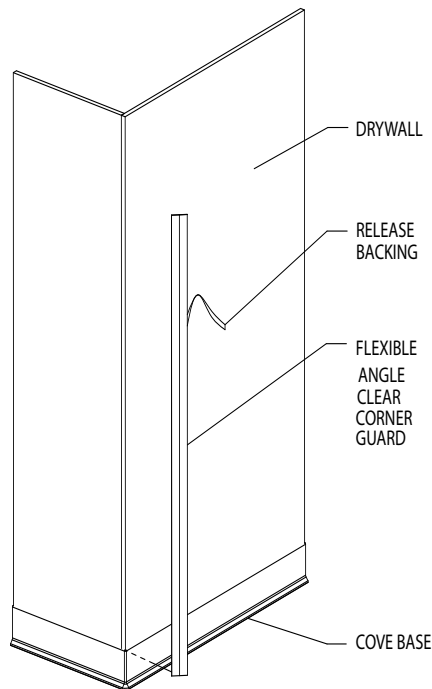

Please read all instructions before installing corner guards. Material must be stored, installed and used in environmentally controlled conditions.

1. Allow corner guards to reach room temperature before installing. The wall surface that the corner guards are to be applied must be dry and free of dirt, dust, oil, loose paint, wax and grease.
2. Peel the release backing from the corner guard. Position the inner apex of the corner guard to the corner of the wall. Press the wings of the corner guard tight against the wall. See Figure 1.
3. Apply firm pressure to the entire surface of the corner guard to ensure a firm bond. An extension roller will aid this step. See Figure 2.

Note: Self-adhesive corner guards are not recommended to be installed in heavy traffic areas or on non-porous, non-smooth, or difficult surfaces, such as glazed block, vinyl wall covering or wall paper.

FIG. 2

