

Installation Instructions

1600i/1655i/G2-1600i Wall Guard

Please read all instructions before installing Wall Guard.

Important

1. Acclimate materials 24 hrs before installation. Maintain temperature controlled environment after installation.
2. Install in accordance with manufacturer's installation instructions. Failure to do so will void the warranty.

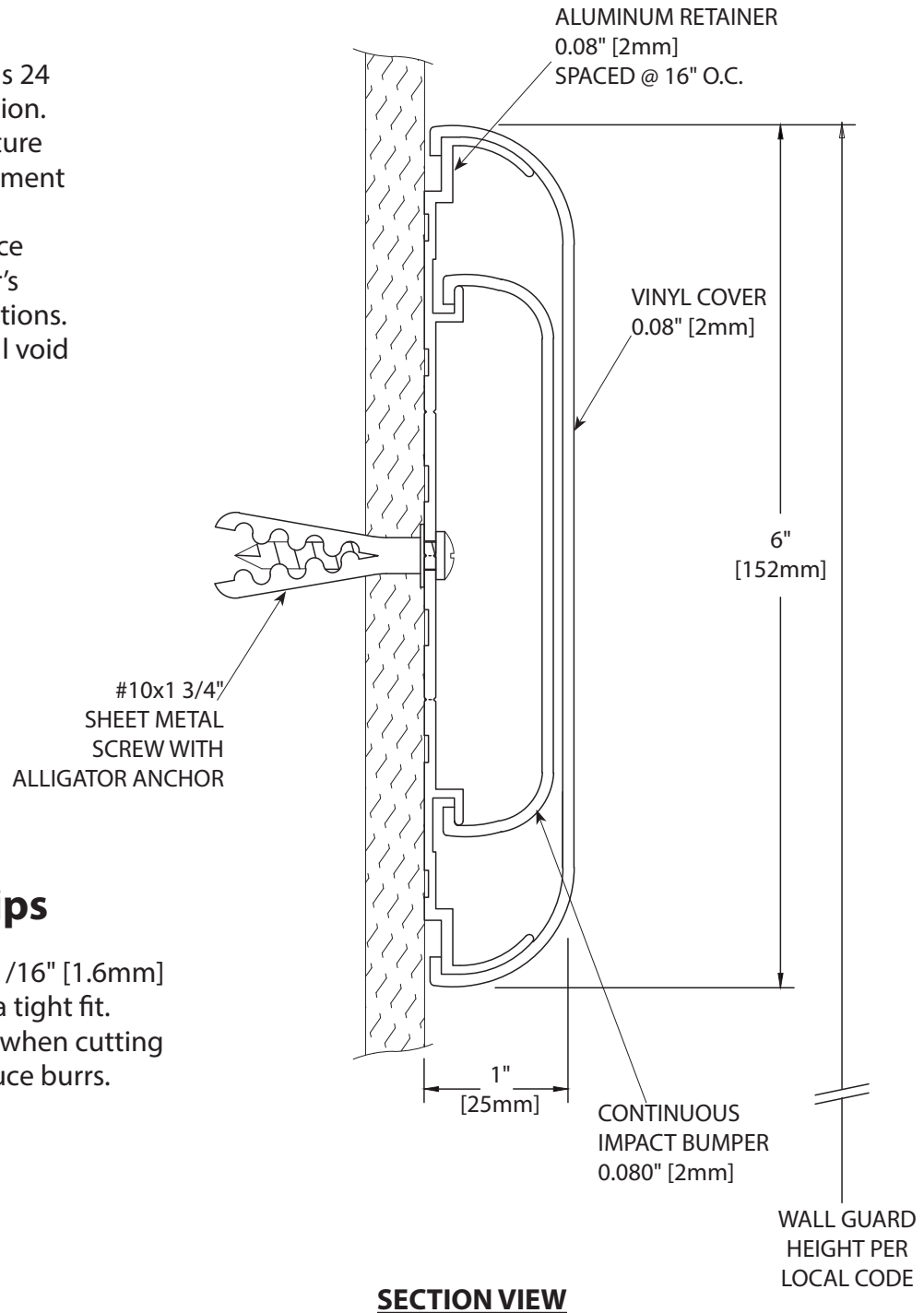

Installation tips

1. Cut covers up to 1/16" [1.6mm] longer to ensure a tight fit.
2. Lubricate blades when cutting aluminum to reduce burrs.

RECOMMENDED TOOLS

Safety Glasses, Tape Measure, Power Drill, Drill Bits - 1/4" masonry (concrete/concrete block), Power Miter Saw, 10" Blade with 60-80 Carbide Tipped Teeth

IPC.351/REV.9

Installation Hotline . 866.EZINPRO

Inprocorp.com . 800.222.5556 . 262.679.9010

World Headquarters S80 W18766 Apollo Drive, Muskego, WI 53150 USA

IPC® •
DOOR + WALL PROTECTION SYSTEMS
A DIVISION OF INPRO®

Installation Instructions

1600i/1655i/G2-1600i Wall Guard

Components and Fasteners

Please read all instructions before installing Wall Guard.



1600V
VINYL COVER

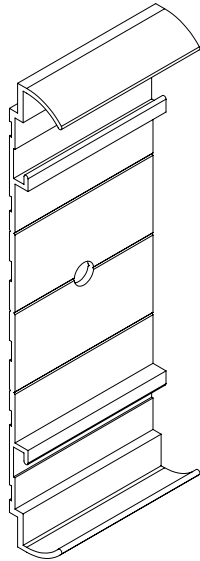

1620AI
ALUMINUM RETAINER

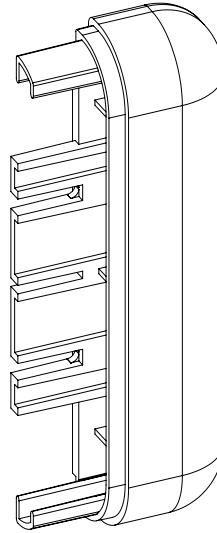

1622
END CAP

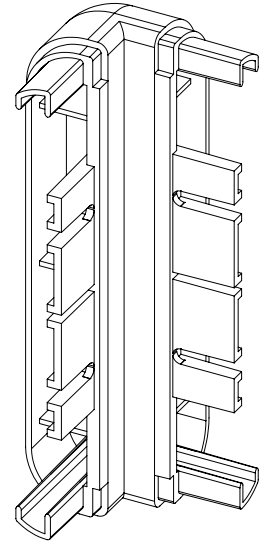

1623
OUTSIDE CORNER

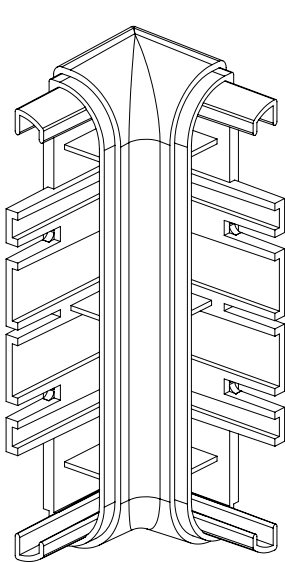

1627
INSIDE CORNER

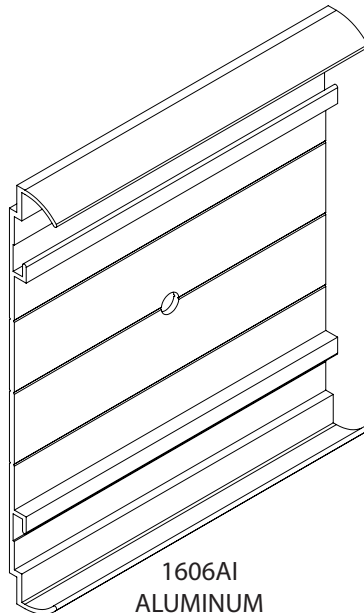

1606AI
ALUMINUM
SPLICE SUPPORT



700B
VINYL IMPACT
BUMPER

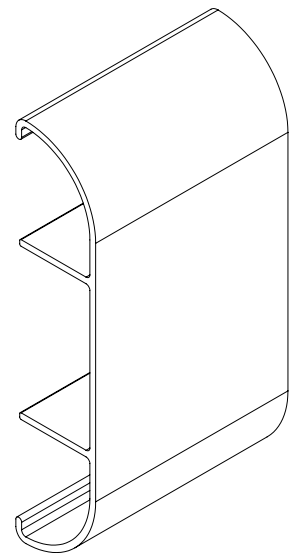

706A
ALUMINUM SPLICE

Fasteners

Wall Condition	Specified Fasteners	Inpro part #
Wall Guard Profile Hardware	#10 1 3/4" Phillips pan head sheet metal screw with alligator anchor	HWK-WG/CR
Concrete Hardware for Corners	#10 1 3/4" Phillips pan head sheet metal screw with alligator anchor	HWK-CC
Drywall Hardware for Corners	#8 x 1 1/2" Phillips Indented Hex Washer Self-Drilling Screw #2PT ZP	HWK-CDW

Installation Hotline . 866.EZINPRO

Inprocorp.com . 800.222.5556 . 262.679.9010

World Headquarters S80 W18766 Apollo Drive, Muskego, WI 53150 USA

IPC® •

DOOR + WALL PROTECTION SYSTEMS
A DIVISION OF INPRO®

Installation Instructions

1600i/1655i/G2-1600i Wall Guard

Please read all instructions before installing Wall Guard.

Layout View

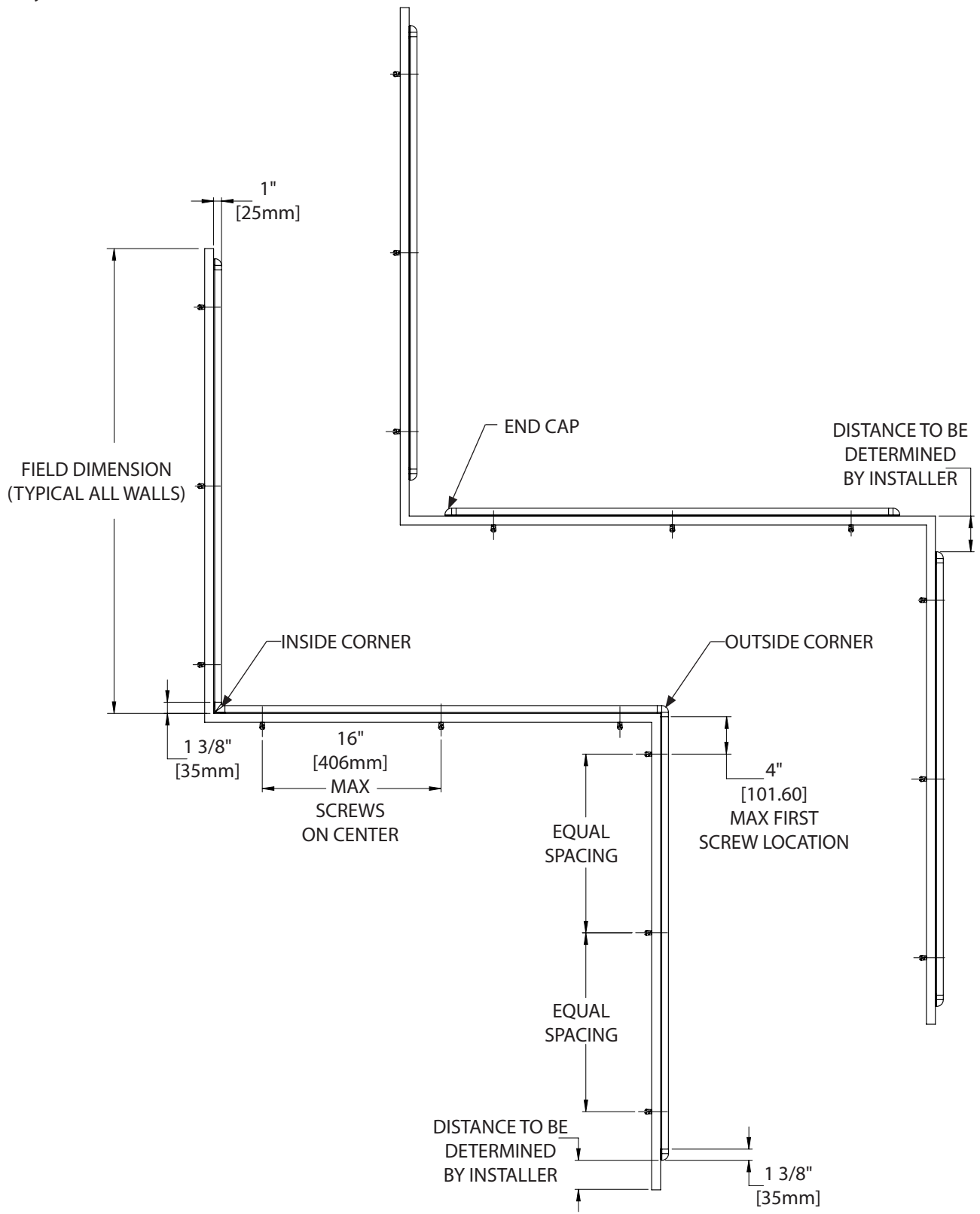

Installation Hotline . 866.EZINPRO

Inprocorp.com . 800.222.5556 . 262.679.9010

World Headquarters S80 W18766 Apollo Drive, Muskego, WI 53150 USA

IPC® •

DOOR + WALL PROTECTION SYSTEMS
A DIVISION OF INPRO®

Installation Instructions

1600i/1655i/G2-1600i Wall Guard

Exploded Assembly View

Please read all instructions before installing Wall Guard.

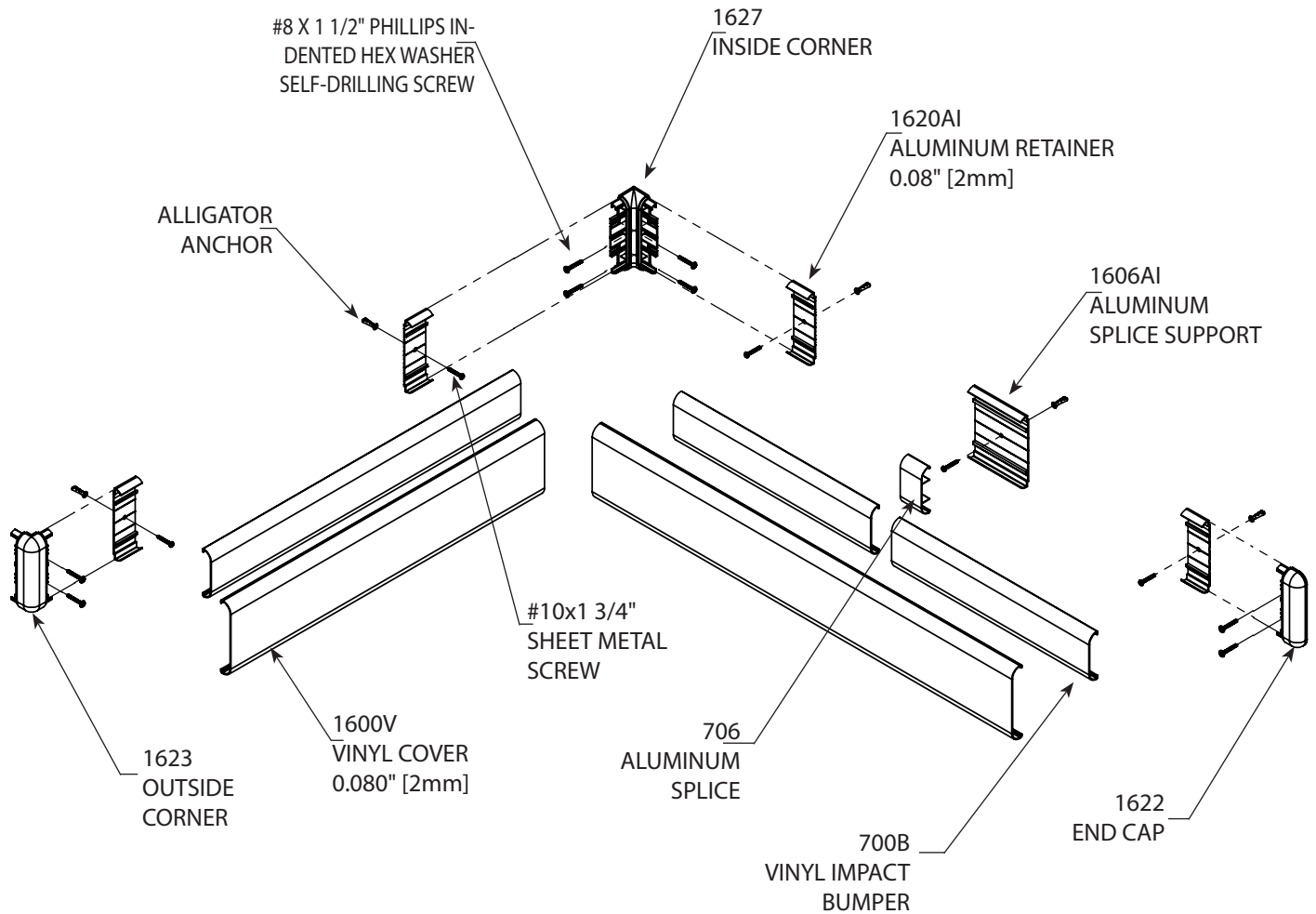

Installation Hotline . 866.EZINPRO

Inprocorp.com . 800.222.5556 . 262.679.9010

World Headquarters S80 W18766 Apollo Drive, Muskego, WI 53150 USA

IPC® •

DOOR + WALL PROTECTION SYSTEMS
A DIVISION OF INPRO®

Installation Instructions

1600i/1655i/G2-1600i Wall Guard

Please read all instructions before installing Wall Guard.

FIG. 1

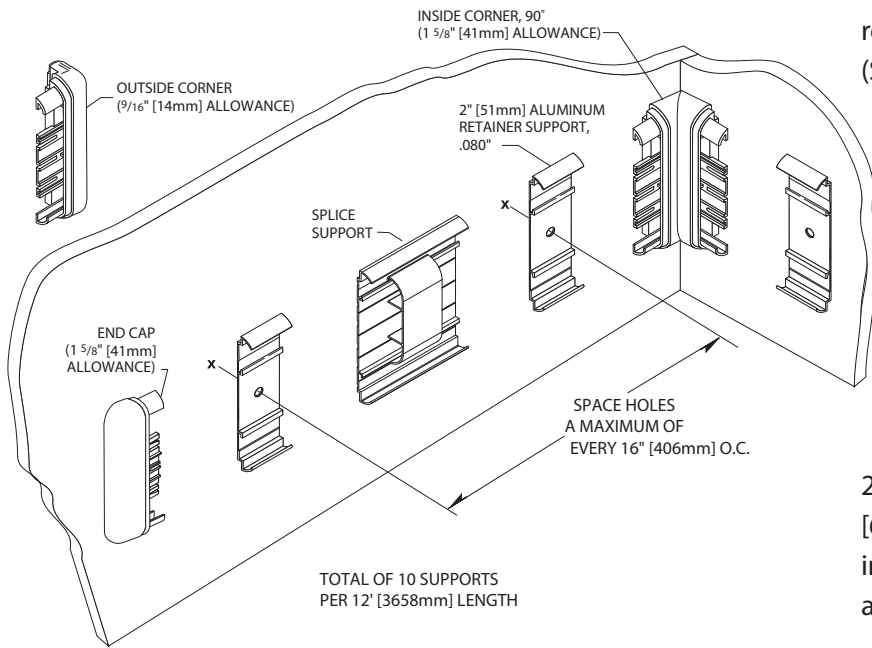

1. Determine height of wall guard on wall. Measure down 3" [76mm] and snap chalk line. Mark mounting holes leaving allowance for returns, outside corners and inside corners. (See Figure 1.)

2. Drill marked holes on wall using a 1/4" [6mm] drill bit and position Alligator anchors into holes. Mount retainer supports on wall and tighten screws to secure. (See Figure 2.)

NOTE: With lengths over 12', an aluminum splice support is recommended behind butt joints for added support. (See Figure 2a.)

NOTE: For concrete or brick wall installation, drill 1/4" [6mm] holes, 3/8" [10mm] from end of retainer for end caps/corners.

FIG. 2

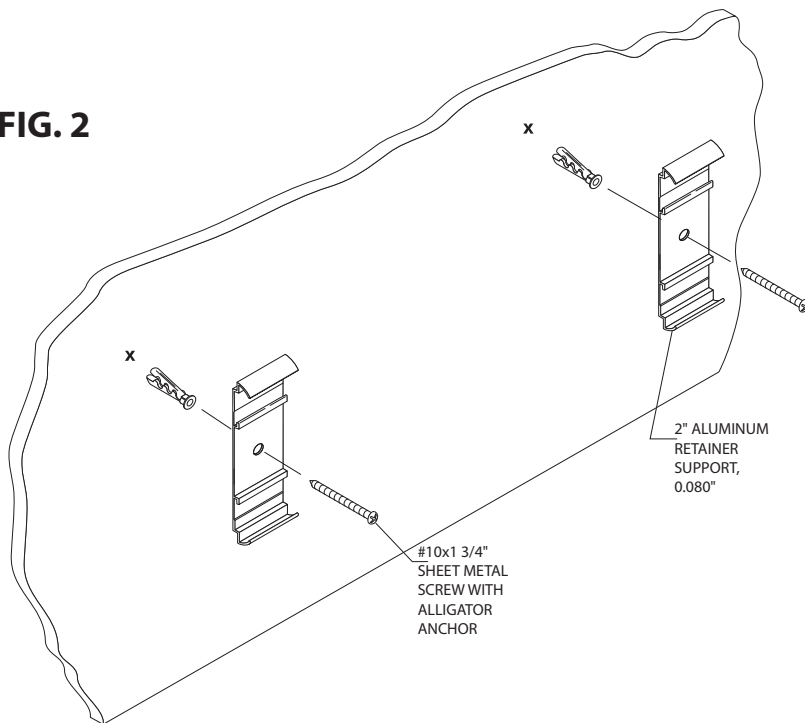
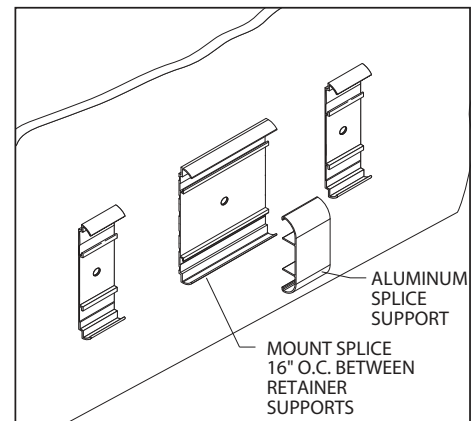

FIG. 2a



Installation Hotline . 866.EZINPRO
 Inprocorp.com . 800.222.5556 . 262.679.9010
 World Headquarters S80 W18766 Apollo Drive, Muskego, WI 53150 USA

IPC®
 DOOR + WALL PROTECTION SYSTEMS
 A DIVISION OF INPRO®

Installation Instructions

1600i/1655i/G2-1600i Wall Guard

Please read all instructions before installing Wall Guard.

FIG. 3

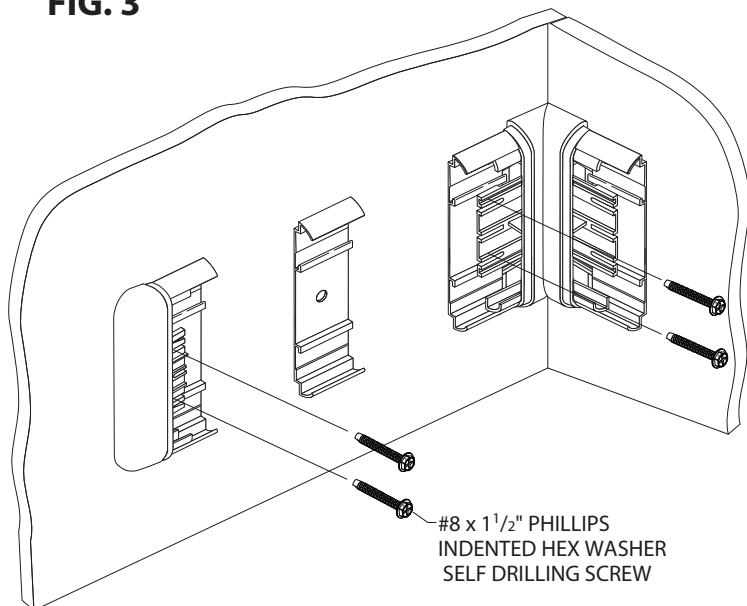

3. Slide end caps and corners onto the retainer support and secure, leaving a 1/16"[1.5mm] gap between returns/corners and retainer to allow for adjustment. (See Figure 3.)

NOTE: For concrete or brick wall installation, use #10 x 1 3/4" Phillips pan head screws to secure retainer to the wall.

FIG. 4

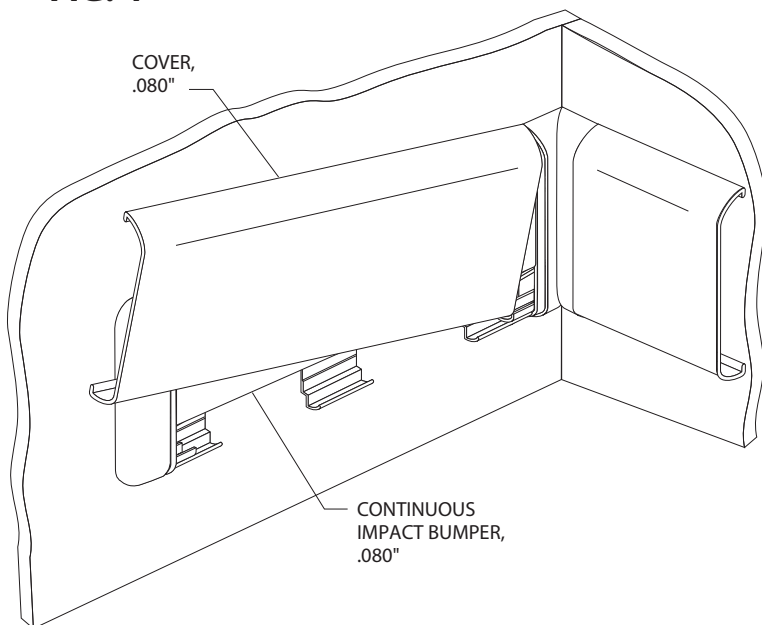

4. Cut the impact bumper to the length between the inside edge of the end caps/corners/splice. Position and snap bumper in place. Cut the cover to length between end caps and/or corners.

(Note: Trim factory edges square before installation). Position cover on retainer and adjust returns and/or corners for a tight fit. Starting at one end of retainer supports, push cover over the retainer supports until it snaps into place. (See Figure 4.)

NOTE: For 1655I Only - When continuous runs are over 12' [3658], covers should be installed in consecutive order using the numbers found on the back of covers. This ensures proper alignment.

Installation Hotline . 866.EZINPRO

Inprocorp.com . 800.222.5556 . 262.679.9010

World Headquarters S80 W18766 Apollo Drive, Muskego, WI 53150 USA

IPC® •

DOOR + WALL PROTECTION SYSTEMS
A DIVISION OF INPRO®