

# CG-510 Flush Mount Corner Guard

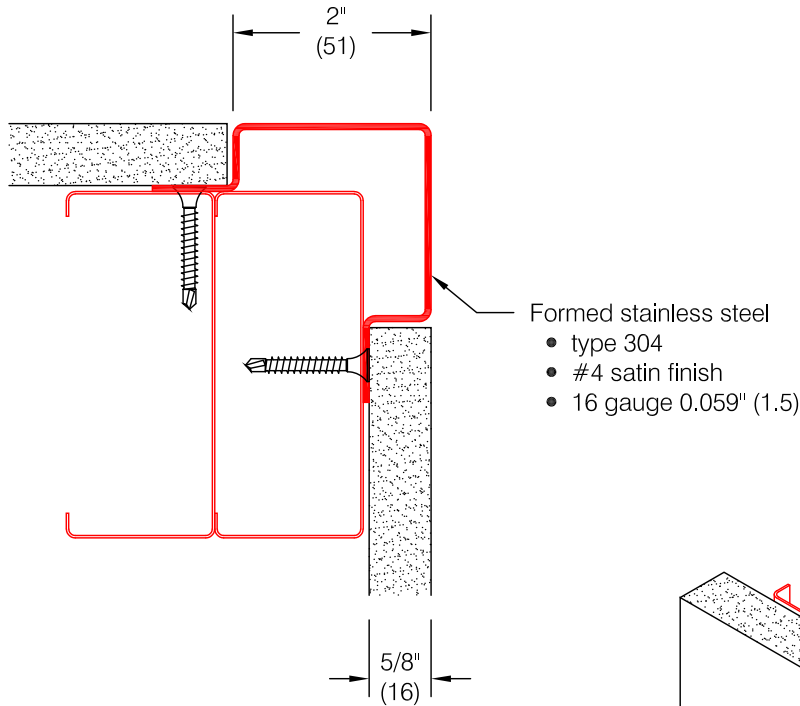

### Features:

- Stock lengths: 4'-0" (1219) & 8'-0" (2438)
- Type 304 stainless
- Custom lengths and wing sizes are available

### Mounting Options:

- Standard mounting
- Drilled:
  - Clearance holes for #8 fastener
- Optional mounting
- Adhesive:
  - ADH-50 adhesive supplied separately

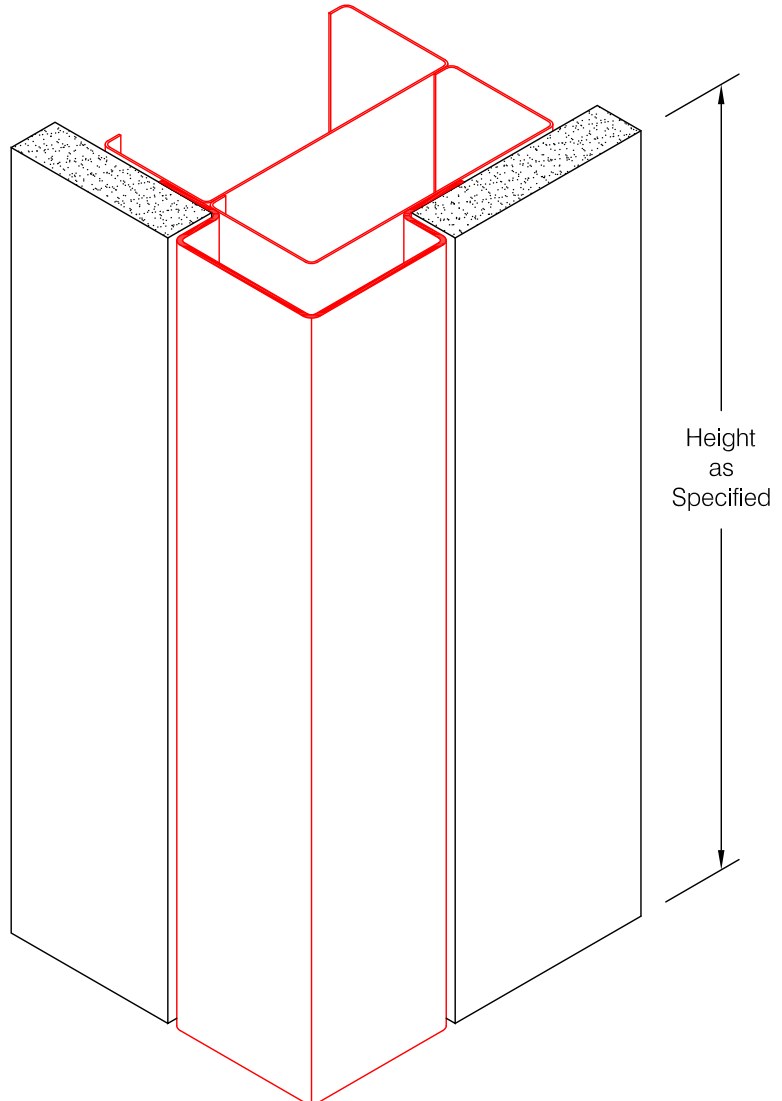

Pawling Corporation reserves the right to discontinue a design or modify an existing design without prior notice

|             |             |          |
|-------------|-------------|----------|
| Customer :  | Project :   | WD.260.0 |
| Architect : | Sales Rep : |          |